

- LEGEND**
- Proposed Development Site Boundary
  - Proposed Development Site Boundary - 15 km Buffer
  - Main Site
  - Local Nature Reserve (LNR)
  - National Nature Reserve (NNR)
  - Ramsar
  - Special Areas of Conservation (SAC)
  - Special Protection Area (SPA)
  - Site of Special Scientific Interest (SSSI)

- NOTES**
- 1: Contains Ordnance Survey Data © Crown Copyright and database right 2023.
  - 2: © Natural England copyright. Contains Ordnance Survey data © Crown Copyright and database right 2023. LNR: NB This national dataset is "indicative" not "definitive". Definitive information can only be provided by individual local authorities and you should refer directly to their information for all purposes that require the most up to date and complete dataset.

**ISSUE PURPOSE**  
PEI Report

**PROJECT NUMBER**  
60689030

**FIGURE TITLE**  
Statutory Designated Ecological Sites within 15 km of the Proposed Development Site Boundary

**FIGURE NUMBER**  
Figure 12-1

This drawing has been prepared for the use of AECOM's client. It may not be used, modified, reproduced or relied upon by third parties, except as agreed by AECOM or as required by law. AECOM accepts no responsibility, and denies any liability whatsoever, to any party that uses or relies on this drawing without AECOM's express written consent. Do not scale this document. All measurements must be obtained from the stated dimensions.

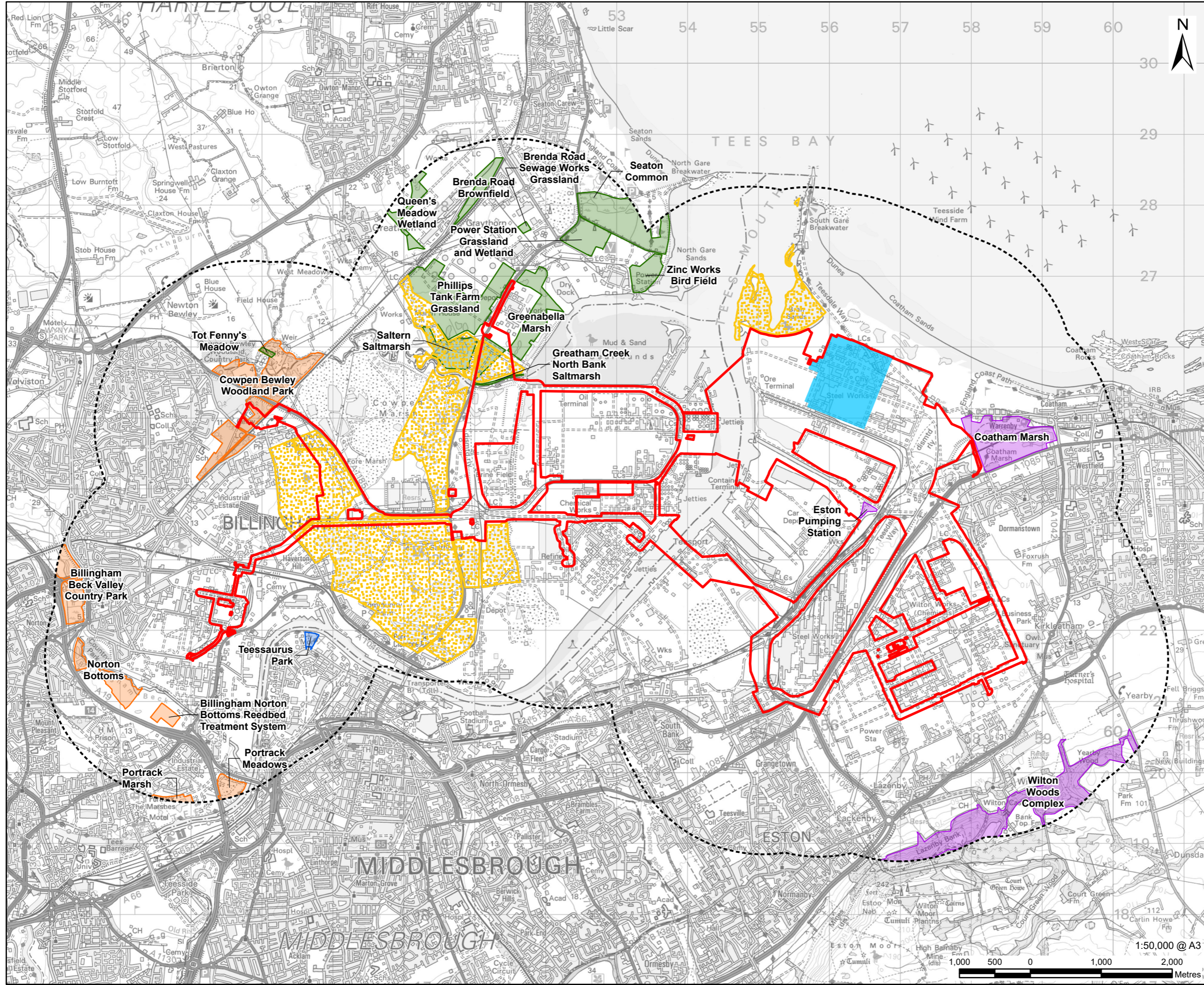

**LEGEND**

- Proposed Development Site Boundary
- Proposed Development Site Boundary - 2 km Buffer
- Main Site
- Saltholme RSPB Reserve
- Local Wildlife Site (LWS)**
- Hartlepool
- Stockton
- Redcar and Cleveland
- Middlesbrough

- NOTES**
- 1: Reproduced from Ordnance Survey digital map data © Crown copyright 2023. All rights reserved. Licence number 0100031673.
  - 2: Local Wildlife Sites provided by Environmental Records Information Centre North East (ERIC), (2022). Data licensed through Public Sector Mapping Agreement © Crown Copyright.
  - 3: Data reproduced with the permission of RSPB. © Crown Copyright. Ordnance Survey licence number 100021787 (2023)

**ISSUE PURPOSE**  
PEI Report

**PROJECT NUMBER**  
60689030

**FIGURE TITLE**  
Non-Statutory Designated Sites

**FIGURE NUMBER**  
Figure 12-2

1:50,000 @ A3

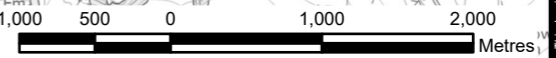

This drawing has been prepared for the use of AECOM's client. It may not be used, modified, reproduced or relied upon by third parties, except as agreed by AECOM or as required by law. AECOM accepts no responsibility, and denies any liability whatsoever, to any party that uses or relies on this drawing without AECOM's express written consent. Do not scale this document. All measurements must be obtained from the stated dimensions.

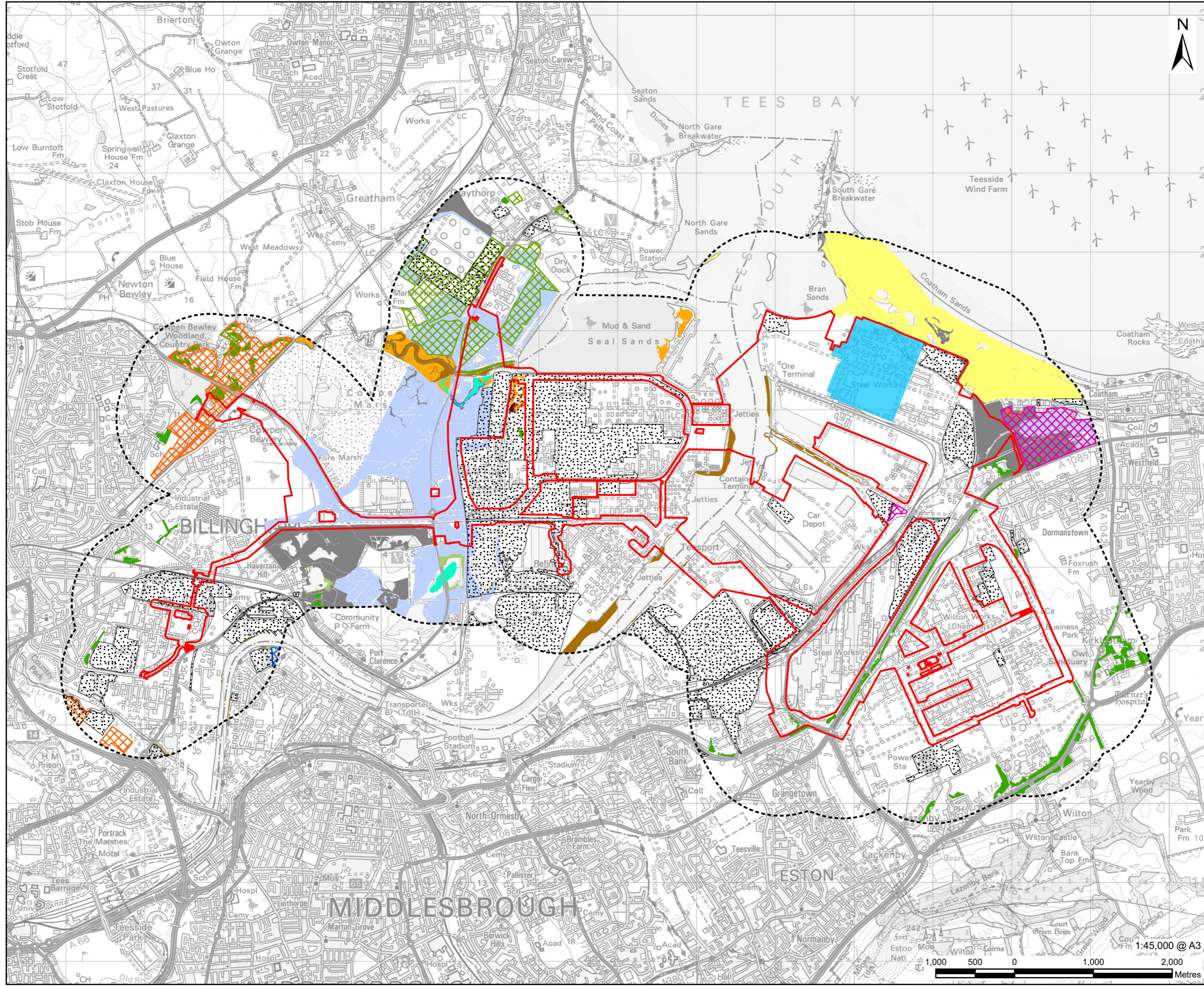

# AECOM

**PROJECT**  
H2 Teesside DCO

**APPLICANT**  
H2 Teesside Limited

**CONSULTANT**  
AECOM Limited  
100 Embankment,  
Cathedral Approach,  
Manchester, M3 7FB  
www.aecom.com

- LEGEND**
- Proposed Development Site Boundary
  - Proposed Development Site Boundary - 1 km Buffer
  - Main Site
  - Priority Habitat**
  - Coastal and floodplain grazing marsh
  - Coastal saltmarsh
  - Coastal sand dunes
  - Deciduous woodland
  - Lowland fens
  - Mudflats
  - No main habitat but additional habitats present
  - Reedbeds
  - Saline lagoons
  - Coastal and floodplain grazing marsh, Coastal saltmarsh
  - Coastal saltmarsh, Saline lagoons
  - Reedbeds, Coastal saltmarsh
  - Open Mosaic Habitat
  - Local Wildlife Site (LWS)**
  - Stockton
  - Redcar and Cleveland
  - Middlesbrough
  - Hartlepool

- NOTES**
- 1: Reproduced from Ordnance Survey digital map data © Crown copyright 2023. All rights reserved. Licence number 0100031673.
  - 2: Data licensed under the Open Government License v3.0. Contains data created and provided by Cumbria Biodiversity Data Centre on behalf of Cumbria Wildlife Trust. The data has been extracted from Cumbria Wildlife Trust's Grassland Inventory and is used under the CC BY 4.0 International licence terms.
  - 3: Local Wildlife Sites provided by Environmental Records Information Centre North East (ERIC), (2022). Data licensed through Public Sector Mapping Agreement © Crown Copyright.
  - 4: © Natural England copyright. Contains Ordnance Survey data © Crown copyright and database right 2023.

**ISSUE PURPOSE**  
PEI Report

**PROJECT NUMBER**  
60689030

**FIGURE TITLE**  
Non-Statutory Ecological Constraints within 1 km of the Proposed Development Site Boundary

**FIGURE NUMBER**  
Figure 12-3



This drawing has been prepared for the use of AECOM's client. It may not be used, modified, reproduced or relied upon by third parties, except as agreed by AECOM or as required by law. AECOM accepts no responsibility, and denies any liability whatsoever, to any party that uses or relies on this drawing without AECOM's express written consent. Do not scale this document. All measurements must be obtained from the stated dimensions.

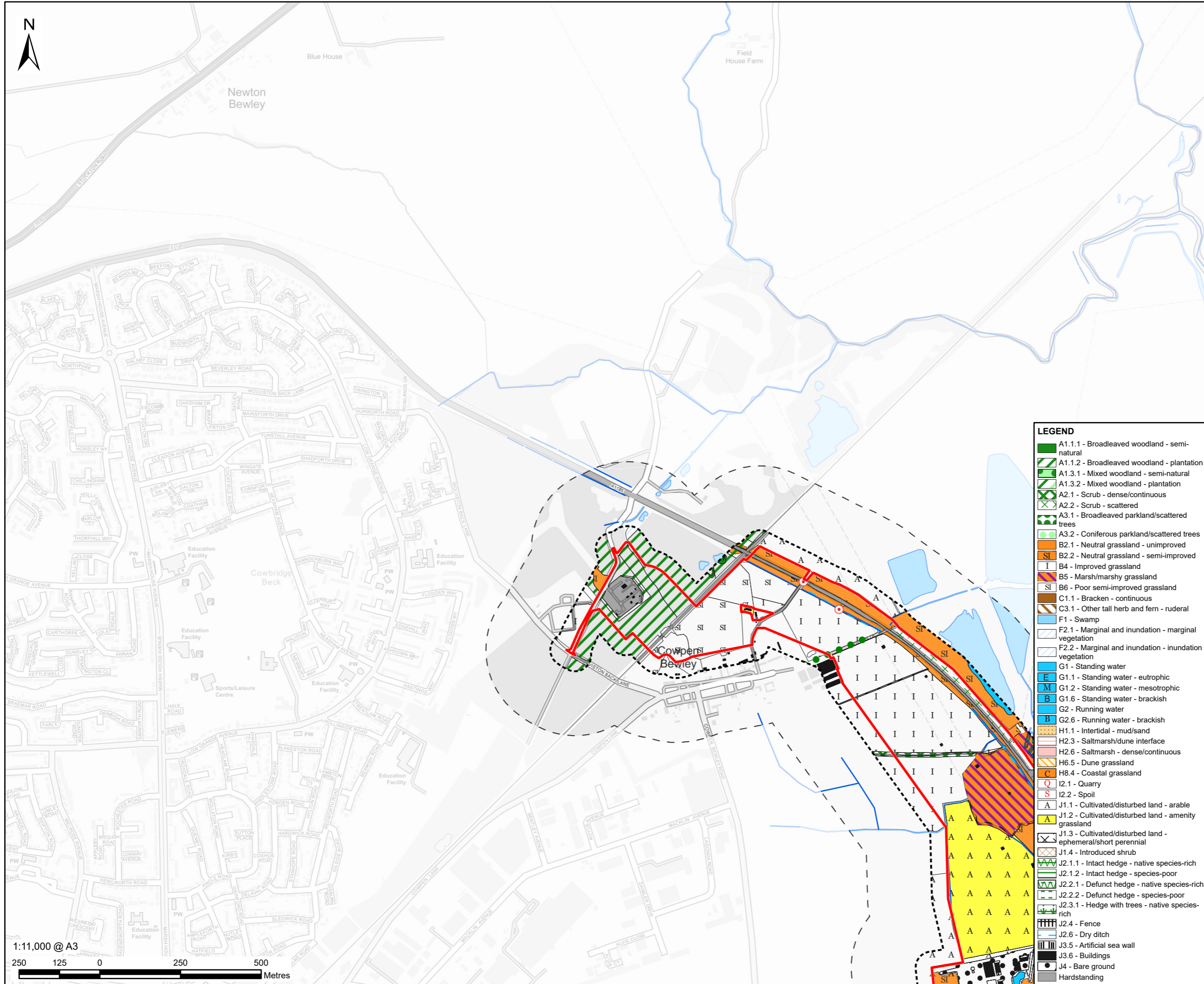

1:11,000 @ A3  
 250 125 0 250 500 Metres

- LEGEND**
- Proposed Development Site Boundary
  - Proposed Development Site Boundary - 50 m Buffer
  - Proposed Development Site Boundary - 250 m Buffer
  - Target Note
  - X A2.2 - Scrub - scattered
  - A3.1 - Broadleaved parkland/scattered trees
  - J5 - Other habitat
  - X A2.2 - Scrub - scattered
  - J2.6 - Dry ditch
  - J2.2.2 - Defunct hedge - species-poor
  - J2.1.2 - Intact hedge - species-poor
  - J2.3.2 - Hedge with trees - species-poor
  - F2.1 - Marginal and inundation - marginal vegetation
  - A3.1 - Broadleaved parkland/scattered trees
  - G2 - Running water
  - Watercourse
  - Waterbody

- LEGEND**
- A1.1.1 - Broadleaved woodland - semi-natural
  - A1.1.2 - Broadleaved woodland - plantation
  - A1.3.1 - Mixed woodland - semi-natural
  - A1.3.2 - Mixed woodland - plantation
  - A2.1 - Scrub - dense/continuous
  - A2.2 - Scrub - scattered
  - A3.1 - Broadleaved parkland/scattered trees
  - A3.2 - Coniferous parkland/scattered trees
  - B2.1 - Neutral grassland - unimproved
  - B2.2 - Neutral grassland - semi-improved
  - B4 - Improved grassland
  - B5 - Marsh/marshy grassland
  - B6 - Poor semi-improved grassland
  - C1.1 - Bracken - continuous
  - C3.1 - Other tall herb and fern - ruderal
  - F1 - Swamp
  - F2.1 - Marginal and inundation - marginal vegetation
  - F2.2 - Marginal and inundation - inundation vegetation
  - G1 - Standing water
  - G1.1 - Standing water - eutrophic
  - G1.2 - Standing water - mesotrophic
  - G1.6 - Standing water - brackish
  - G2 - Running water
  - G2.6 - Running water - brackish
  - H1.1 - Intertidal - mud/sand
  - H2.3 - Saltmarsh/dune interface
  - H2.6 - Saltmarsh - dense/continuous
  - H6.5 - Dune grassland
  - H8.4 - Coastal grassland
  - I2.1 - Quarry
  - I2.2 - Spoil
  - J1.1 - Cultivated/disturbed land - arable
  - J1.2 - Cultivated/disturbed land - amenity grassland
  - J1.3 - Cultivated/disturbed land - ephemeral/short perennial
  - J1.4 - Introduced shrub
  - J2.1.1 - Intact hedge - native species-rich
  - J2.1.2 - Intact hedge - species-poor
  - J2.2.1 - Defunct hedge - native species-rich
  - J2.2.2 - Defunct hedge - species-poor
  - J2.3.1 - Hedge with trees - native species-rich
  - J2.4 - Fence
  - J3.5 - Artificial sea wall
  - J3.6 - Buildings
  - J4 - Bare ground
  - Hardstanding

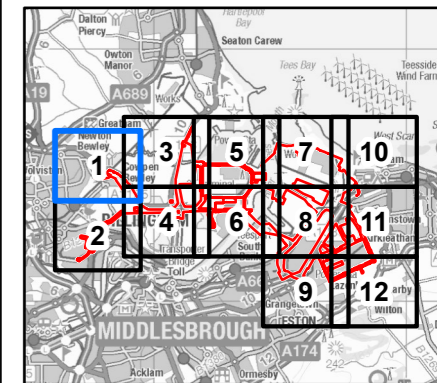

**NOTES**  
 1: Contains Ordnance Survey Data © Crown Copyright and database right 2023.

**ISSUE PURPOSE**  
 PEI Report

**PROJECT NUMBER**  
 60689030

**FIGURE TITLE**  
 Phase 1 Habitat Map (Draft)

**FIGURE NUMBER**  
 Figure 12-4 (Sheet 1 of 12)

This drawing has been prepared for the use of AECOM's client. It may not be used, modified, reproduced or relied upon by third parties, except as agreed by AECOM or as required by law. AECOM accepts no responsibility, and denies any liability whatsoever, to any party that uses or relies on this drawing without AECOM's express written consent. Do not scale this document. All measurements must be obtained from the stated dimensions.

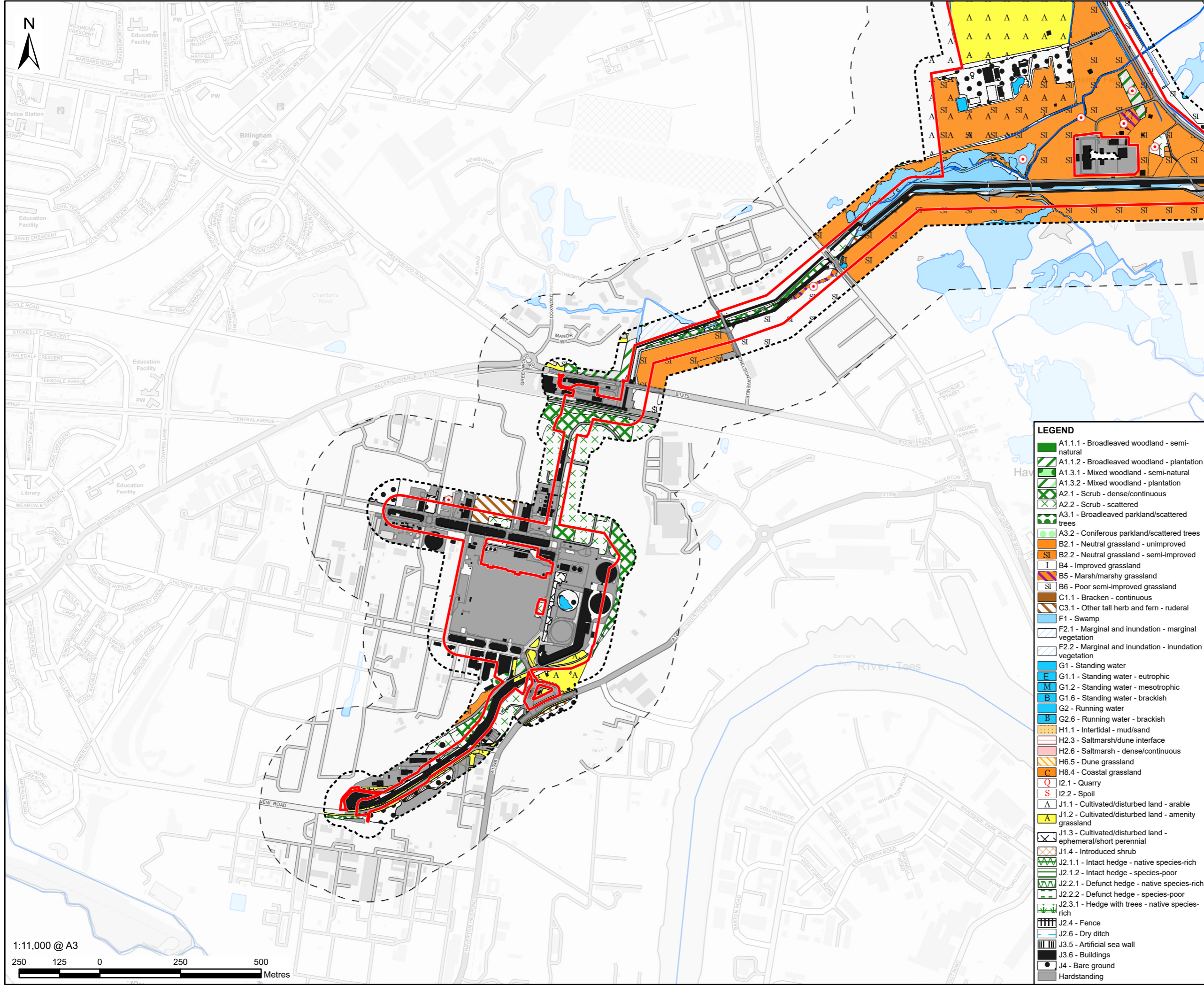

1:11,000 @ A3  
 250 125 0 250 500 Metres

**LEGEND**

- Proposed Development Site Boundary
- Proposed Development Site Boundary - 50 m Buffer
- Proposed Development Site Boundary - 250 m Buffer
- Target Note
- X A2.2 - Scrub - scattered
- A3.1 - Broadleaved parkland/scattered trees
- J5 - Other habitat
- X A2.2 - Scrub - scattered
- J2.6 - Dry ditch
- J2.2.2 - Defunct hedge - species-poor
- J2.1.2 - Intact hedge - species-poor
- J2.3.2 - Hedge with trees - species-poor
- F2.1 - Marginal and inundation - marginal vegetation
- F2.2 - Marginal and inundation - inundation vegetation
- A3.1 - Broadleaved parkland/scattered trees
- G2 - Running water
- Watercourse
- Waterbody

**LEGEND**

- A1.1.1 - Broadleaved woodland - semi-natural
- A1.1.2 - Broadleaved woodland - plantation
- A1.3.1 - Mixed woodland - semi-natural
- A1.3.2 - Mixed woodland - plantation
- A2.1 - Scrub - dense/continuous
- A2.2 - Scrub - scattered
- A3.1 - Broadleaved parkland/scattered trees
- A3.2 - Coniferous parkland/scattered trees
- B2.1 - Neutral grassland - unimproved
- B2.2 - Neutral grassland - semi-improved
- B4 - Improved grassland
- B5 - Marsh/marshy grassland
- B6 - Poor semi-improved grassland
- C1.1 - Bracken - continuous
- C3.1 - Other tall herb and fern - ruderal
- F1 - Swamp
- F2.1 - Marginal and inundation - marginal vegetation
- F2.2 - Marginal and inundation - inundation vegetation
- G1 - Standing water
- E G1.1 - Standing water - eutrophic
- M G1.2 - Standing water - mesotrophic
- B G1.6 - Standing water - brackish
- G2 - Running water
- B G2.6 - Running water - brackish
- H1.1 - Intertidal - mud/sand
- H2.3 - Saltmarsh/dune interface
- H2.6 - Saltmarsh - dense/continuous
- H6.5 - Dune grassland
- C H8.4 - Coastal grassland
- Q I2.1 - Quarry
- S I2.2 - Spoil
- A J1.1 - Cultivated/disturbed land - arable
- A J1.2 - Cultivated/disturbed land - amenity grassland
- J1.3 - Cultivated/disturbed land - ephemeral/short perennial
- J1.4 - Introduced shrub
- J2.1.1 - Intact hedge - native species-rich
- J2.1.2 - Intact hedge - species-poor
- J2.2.1 - Defunct hedge - native species-rich
- J2.2.2 - Defunct hedge - species-poor
- J2.3.1 - Hedge with trees - native species-rich
- J2.4 - Fence
- J2.6 - Dry ditch
- J3.5 - Artificial sea wall
- J3.6 - Buildings
- J4 - Bare ground
- Hardstanding

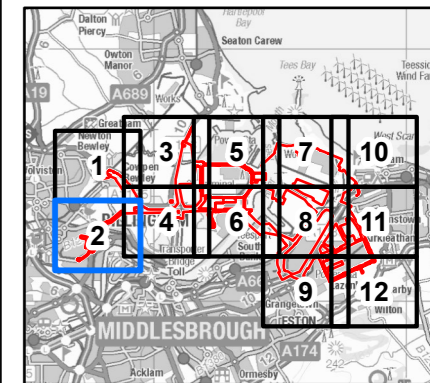

**NOTES**  
 1: Contains Ordnance Survey Data © Crown Copyright and database right 2023.

**ISSUE PURPOSE**  
 PEI Report

**PROJECT NUMBER**  
 60689030

**FIGURE TITLE**  
 Phase 1 Habitat Map (Draft)

**FIGURE NUMBER**  
 Figure 12-4 (Sheet 2 of 12)

This drawing has been prepared for the use of AECOM's client. It may not be used, modified, reproduced or relied upon by third parties, except as agreed by AECOM or as required by law. AECOM accepts no responsibility, and denies any liability whatsoever, to any party that uses or relies on this drawing without AECOM's express written consent. Do not scale this document. All measurements must be obtained from the stated dimensions.

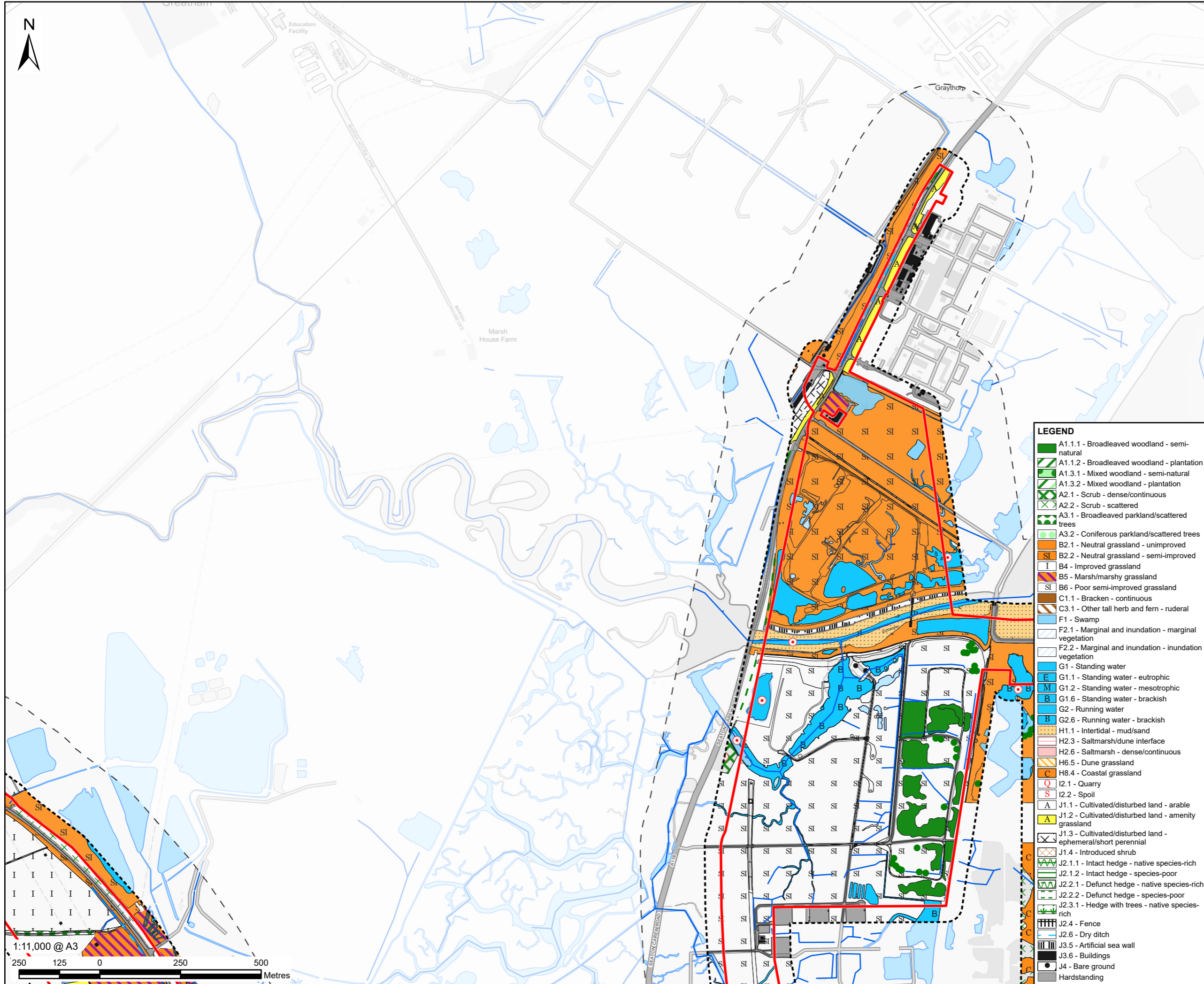

- LEGEND**
- Proposed Development Site Boundary
  - Proposed Development Site Boundary - 50 m Buffer
  - Proposed Development Site Boundary - 250 m Buffer
  - Target Note
  - X A2.2 - Scrub - scattered
  - A3.1 - Broadleaved parkland/scattered trees
  - J5 - Other habitat
  - X A2.2 - Scrub - scattered
  - J2.6 - Dry ditch
  - J2.2.2 - Defunct hedge - species-poor
  - J2.1.2 - Intact hedge - species-poor
  - J2.3.2 - Hedge with trees - species-poor
  - F2.1 - Marginal and inundation - marginal vegetation
  - A3.1 - Broadleaved parkland/scattered trees
  - G2 - Running water
  - Watercourse
  - Waterbody

- LEGEND**
- A1.1.1 - Broadleaved woodland - semi-natural
  - A1.1.2 - Broadleaved woodland - plantation
  - A1.3.1 - Mixed woodland - semi-natural
  - A1.3.2 - Mixed woodland - plantation
  - A2.1 - Scrub - dense/continuous
  - X A2.2 - Scrub - scattered
  - A3.1 - Broadleaved parkland/scattered trees
  - A3.2 - Coniferous parkland/scattered trees
  - B2.1 - Neutral grassland - unimproved
  - B2.2 - Neutral grassland - semi-improved
  - B4 - Improved grassland
  - B5 - Marsh/marshy grassland
  - B6 - Poor semi-improved grassland
  - C1.1 - Bracken - continuous
  - C3.1 - Other tall herb and fern - ruderal
  - F1 - Swamp
  - F2.1 - Marginal and inundation - marginal vegetation
  - F2.2 - Marginal and inundation - inundation vegetation
  - G1 - Standing water
  - G1.1 - Standing water - eutrophic
  - G1.2 - Standing water - mesotrophic
  - G1.6 - Standing water - brackish
  - G2 - Running water
  - G2.6 - Running water - brackish
  - H1.1 - Intertidal - mud/sand
  - H2.3 - Saltmarsh/dune interface
  - H2.6 - Saltmarsh - dense/continuous
  - H6.5 - Dune grassland
  - H8.4 - Coastal grassland
  - I2.1 - Quarry
  - I2.2 - Spoil
  - J1.1 - Cultivated/disturbed land - arable
  - J1.2 - Cultivated/disturbed land - amenity grassland
  - J1.3 - Cultivated/disturbed land - ephemeral/short perennial
  - J1.4 - Introduced shrub
  - J2.1.1 - Intact hedge - native species-rich
  - J2.1.2 - Intact hedge - species-poor
  - J2.2.1 - Defunct hedge - native species-rich
  - J2.2.2 - Defunct hedge - species-poor
  - J2.3.1 - Hedge with trees - native species-rich
  - J2.4 - Fence
  - J2.6 - Dry ditch
  - J3.5 - Artificial sea wall
  - J3.6 - Buildings
  - J4 - Bare ground
  - Hardstanding

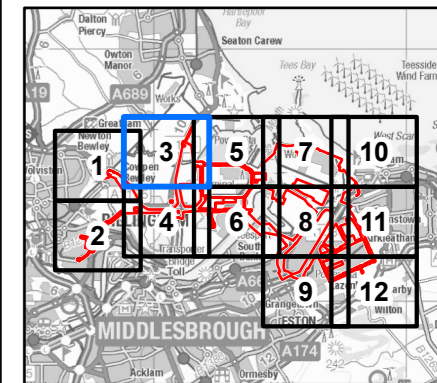

**NOTES**  
1: Contains Ordnance Survey Data © Crown Copyright and database right 2023.

**ISSUE PURPOSE**  
PEI Report

**PROJECT NUMBER**  
60689030

**FIGURE TITLE**  
Phase 1 Habitat Map (Draft)

**FIGURE NUMBER**  
Figure 12-4 (Sheet 3 of 12)

This drawing has been prepared for the use of AECOM's client. It may not be used, modified, reproduced or relied upon by third parties, except as agreed by AECOM or as required by law. AECOM accepts no responsibility, and denies any liability whatsoever, to any party that uses or relies on this drawing without AECOM's express written consent. Do not scale this document. All measurements must be obtained from the stated dimensions.

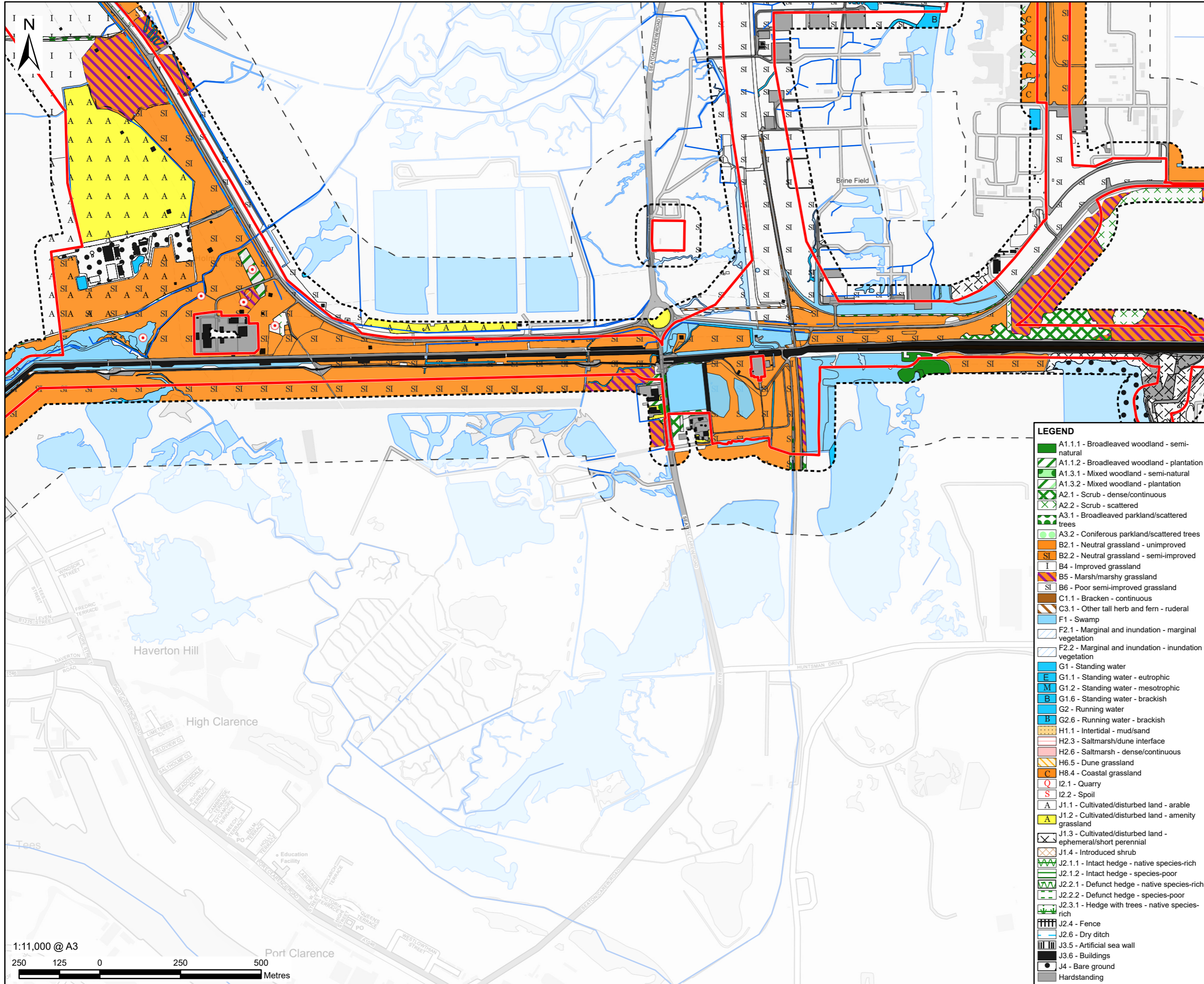

**LEGEND**

- Proposed Development Site Boundary
- Proposed Development Site Boundary - 50 m Buffer
- Proposed Development Site Boundary - 250 m Buffer
- Target Note
- A2.2 - Scrub - scattered
- A3.1 - Broadleaved parkland/scattered trees
- J5 - Other habitat
- X A2.2 - Scrub - scattered
- J2.6 - Dry ditch
- J2.2.2 - Defunct hedge - species-poor
- J2.1.2 - Intact hedge - species-poor
- J2.3.2 - Hedge with trees - species-poor
- F2.1 - Marginal and inundation - marginal vegetation
- A3.1 - Broadleaved parkland/scattered trees
- G2 - Running water
- Watercourse
- Waterbody

**LEGEND**

- A1.1.1 - Broadleaved woodland - semi-natural
- A1.1.2 - Broadleaved woodland - plantation
- A1.3.1 - Mixed woodland - semi-natural
- A1.3.2 - Mixed woodland - plantation
- A2.1 - Scrub - dense/continuous
- A2.2 - Scrub - scattered
- A3.1 - Broadleaved parkland/scattered trees
- A3.2 - Coniferous parkland/scattered trees
- B2.1 - Neutral grassland - unimproved
- B2.2 - Neutral grassland - semi-improved
- B4 - Improved grassland
- B5 - Marsh/marshy grassland
- B6 - Poor semi-improved grassland
- C1.1 - Bracken - continuous
- C3.1 - Other tall herb and fern - ruderal
- F1 - Swamp
- F2.1 - Marginal and inundation - marginal vegetation
- F2.2 - Marginal and inundation - inundation vegetation
- G1 - Standing water
- G1.1 - Standing water - eutrophic
- G1.2 - Standing water - mesotrophic
- G1.6 - Standing water - brackish
- G2 - Running water
- G2.6 - Running water - brackish
- H1.1 - Intertidal - mud/sand
- H2.3 - Saltmarsh/dune interface
- H2.6 - Saltmarsh - dense/continuous
- H6.5 - Dune grassland
- H8.4 - Coastal grassland
- I2.1 - Quarry
- I2.2 - Spoil
- A J1.1 - Cultivated/disturbed land - arable
- A J1.2 - Cultivated/disturbed land - amenity grassland
- J1.3 - Cultivated/disturbed land - ephemeral/short perennial
- J1.4 - Introduced shrub
- J2.1.1 - Intact hedge - native species-rich
- J2.1.2 - Intact hedge - species-poor
- J2.2.1 - Defunct hedge - native species-rich
- J2.2.2 - Defunct hedge - species-poor
- J2.3.1 - Hedge with trees - native species-rich
- J2.4 - Fence
- J2.6 - Dry ditch
- J3.5 - Artificial sea wall
- J3.6 - Buildings
- J4 - Bare ground
- Hardstanding

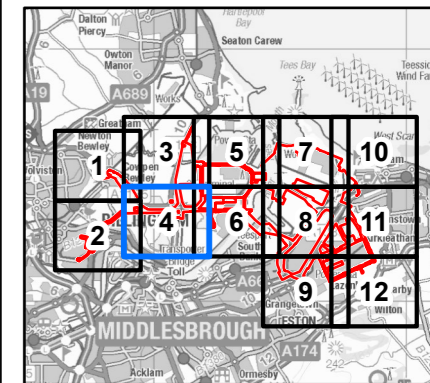

**NOTES**  
1: Contains Ordnance Survey Data © Crown Copyright and database right 2023.

**ISSUE PURPOSE**  
PEI Report

**PROJECT NUMBER**  
60689030

**FIGURE TITLE**  
Phase 1 Habitat Map (Draft)

**FIGURE NUMBER**  
Figure 12-4 (Sheet 4 of 12)

This drawing has been prepared for the use of AECOM's client. It may not be used, modified, reproduced or relied upon by third parties, except as agreed by AECOM or as required by law. AECOM accepts no responsibility, and denies any liability whatsoever, to any party that uses or relies on this drawing without AECOM's express written consent. Do not scale this document. All measurements must be obtained from the stated dimensions.

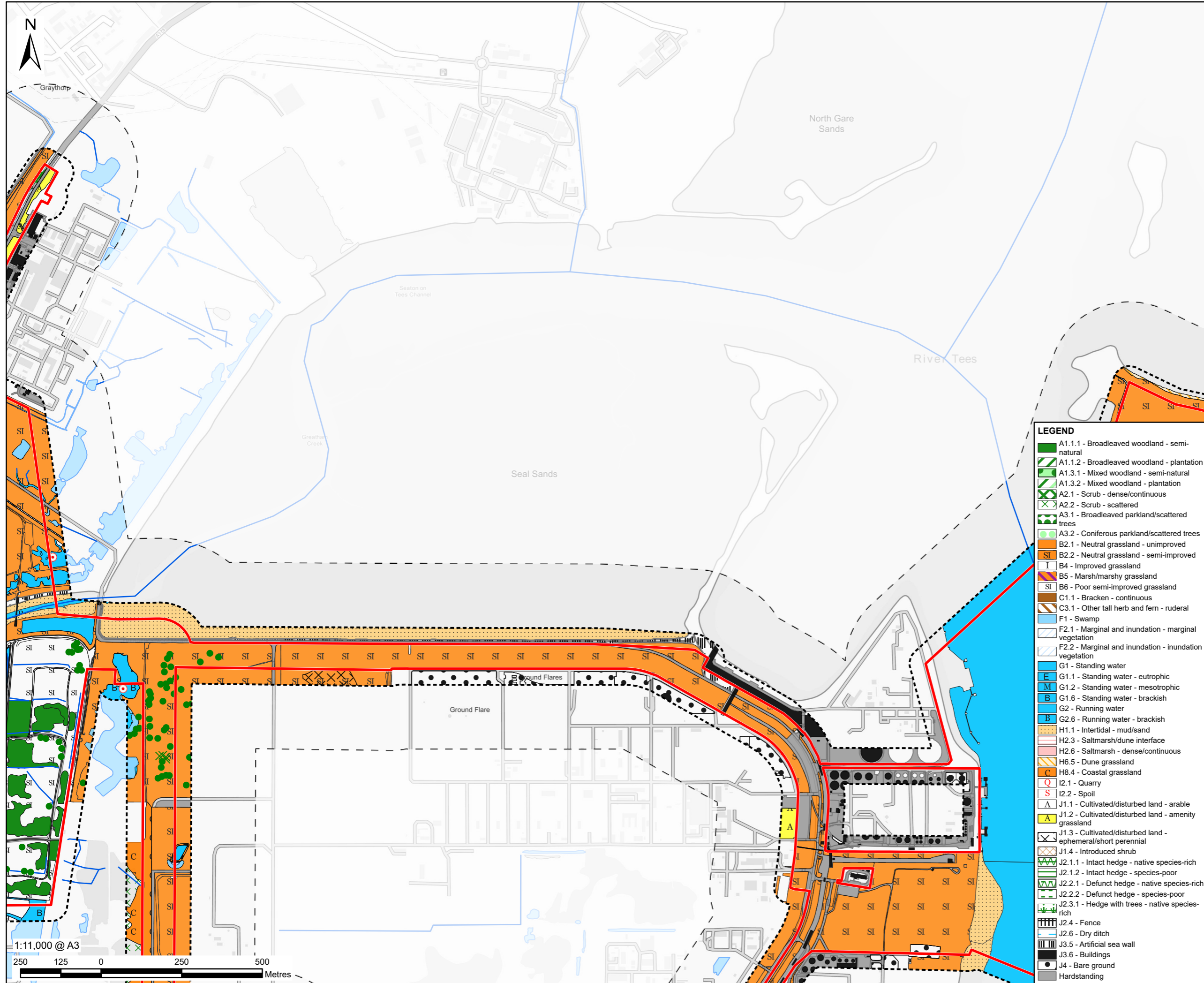

**LEGEND**

- Proposed Development Site Boundary
- Proposed Development Site Boundary - 50 m Buffer
- Proposed Development Site Boundary - 250 m Buffer
- Target Note
- X A2.2 - Scrub - scattered
- A3.1 - Broadleaved parkland/scattered trees
- J5 - Other habitat
- X A2.2 - Scrub - scattered
- J2.6 - Dry ditch
- J2.2.2 - Defunct hedge - species-poor
- J2.1.2 - Intact hedge - species-poor
- J2.3.2 - Hedge with trees - species-poor
- F2.1 - Marginal and inundation - marginal vegetation
- A3.1 - Broadleaved parkland/scattered trees
- G2 - Running water
- Watercourse
- Waterbody

**LEGEND**

- A1.1.1 - Broadleaved woodland - semi-natural
- A1.1.2 - Broadleaved woodland - plantation
- A1.3.1 - Mixed woodland - semi-natural
- A1.3.2 - Mixed woodland - plantation
- A2.1 - Scrub - dense/continuous
- A2.2 - Scrub - scattered
- A3.1 - Broadleaved parkland/scattered trees
- A3.2 - Coniferous parkland/scattered trees
- B2.1 - Neutral grassland - unimproved
- B2.2 - Neutral grassland - semi-improved
- B4 - Improved grassland
- B5 - Marsh/marshy grassland
- B6 - Poor semi-improved grassland
- C1.1 - Bracken - continuous
- C3.1 - Other tall herb and fern - ruderal
- F1 - Swamp
- F2.1 - Marginal and inundation - marginal vegetation
- F2.2 - Marginal and inundation - inundation vegetation
- G1 - Standing water
- G1.1 - Standing water - eutrophic
- G1.2 - Standing water - mesotrophic
- G1.6 - Standing water - brackish
- G2 - Running water
- G2.6 - Running water - brackish
- H1.1 - Intertidal - mud/sand
- H2.3 - Saltmarsh/dune interface
- H2.6 - Saltmarsh - dense/continuous
- H6.5 - Dune grassland
- H8.4 - Coastal grassland
- I2.1 - Quarry
- I2.2 - Spoil
- J1.1 - Cultivated/disturbed land - arable
- J1.2 - Cultivated/disturbed land - amenity grassland
- J1.3 - Cultivated/disturbed land - ephemeral/short perennial
- J1.4 - Introduced shrub
- J2.1.1 - Intact hedge - native species-rich
- J2.1.2 - Intact hedge - species-poor
- J2.2.1 - Defunct hedge - native species-rich
- J2.2.2 - Defunct hedge - species-poor
- J2.3.1 - Hedge with trees - native species-rich
- J2.4 - Fence
- J2.6 - Dry ditch
- J3.5 - Artificial sea wall
- J3.6 - Buildings
- J4 - Bare ground
- Hardstanding

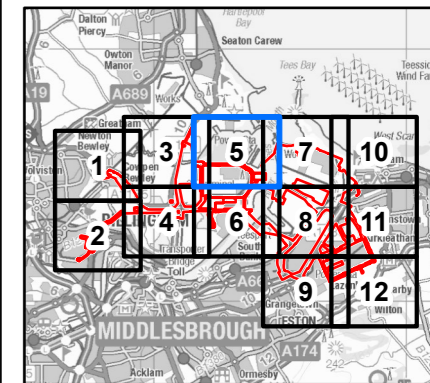

**NOTES**

1: Contains Ordnance Survey Data © Crown Copyright and database right 2023.

**ISSUE PURPOSE**  
PEI Report

**PROJECT NUMBER**  
60689030

**FIGURE TITLE**  
Phase 1 Habitat Map (Draft)

**FIGURE NUMBER**  
Figure 12-4 (Sheet 5 of 12)

This drawing has been prepared for the use of AECOM's client. It may not be used, modified, reproduced or relied upon by third parties, except as agreed by AECOM or as required by law. AECOM accepts no responsibility, and denies any liability whatsoever, to any party that uses or relies on this drawing without AECOM's express written consent. Do not scale this document. All measurements must be obtained from the stated dimensions.



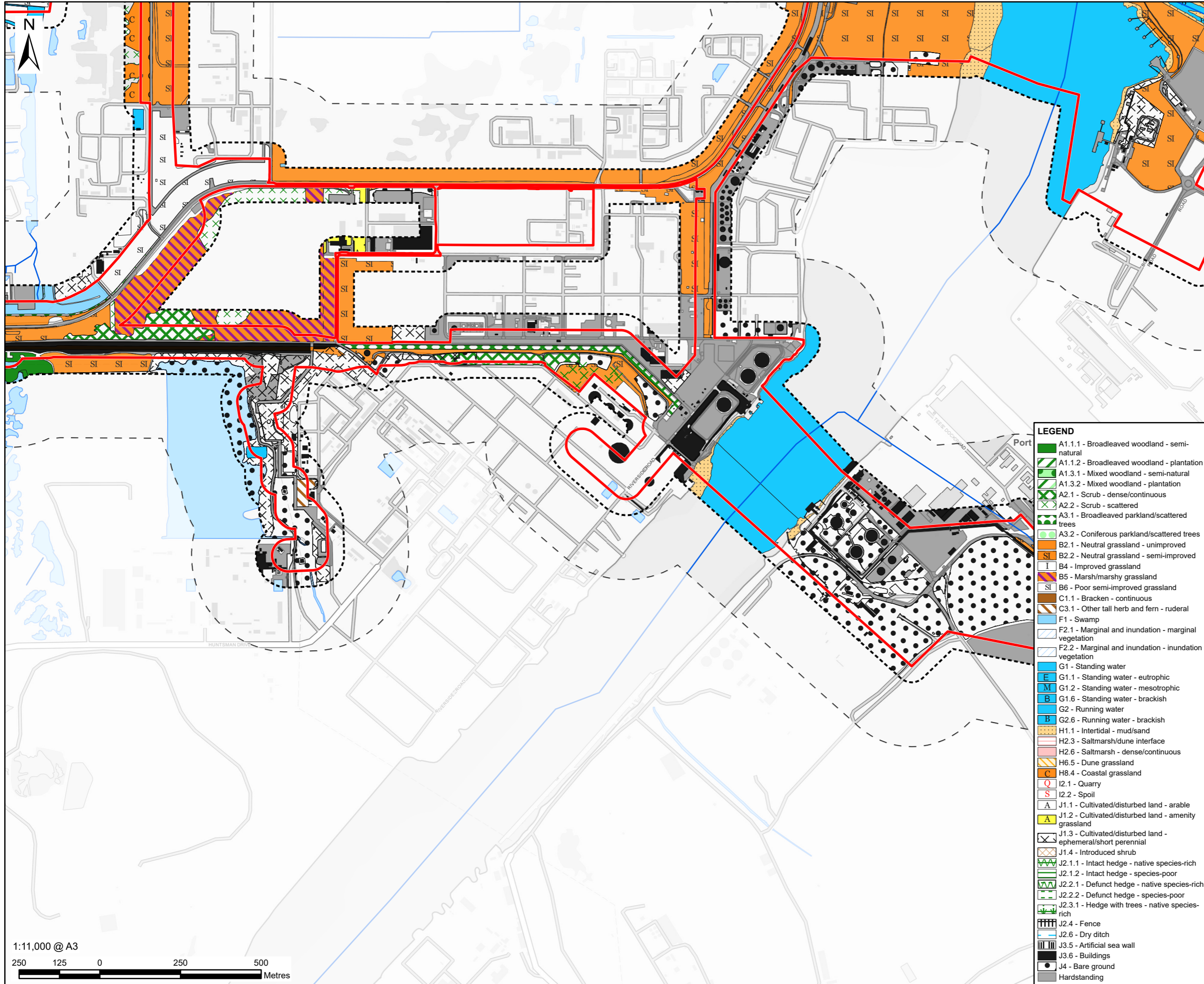

**LEGEND**

- Proposed Development Site Boundary
- Proposed Development Site Boundary - 50 m Buffer
- Proposed Development Site Boundary - 250 m Buffer
- Target Note
- X A2.2 - Scrub - scattered
- A3.1 - Broadleaved parkland/scattered trees
- J5 - Other habitat
- X A2.2 - Scrub - scattered
- J2.6 - Dry ditch
- J2.2.2 - Defunct hedge - species-poor
- J2.1.2 - Intact hedge - species-poor
- J2.3.2 - Hedge with trees - species-poor
- F2.1 - Marginal and inundation - marginal vegetation
- A3.1 - Broadleaved parkland/scattered trees
- G2 - Running water
- Watercourse
- Waterbody

**LEGEND**

- A1.1.1 - Broadleaved woodland - semi-natural
- A1.1.2 - Broadleaved woodland - plantation
- A1.3.1 - Mixed woodland - semi-natural
- A1.3.2 - Mixed woodland - plantation
- A2.1 - Scrub - dense/continuous
- A2.2 - Scrub - scattered
- A3.1 - Broadleaved parkland/scattered trees
- A3.2 - Coniferous parkland/scattered trees
- B2.1 - Neutral grassland - unimproved
- B2.2 - Neutral grassland - semi-improved
- B4 - Improved grassland
- B5 - Marsh/marshy grassland
- B6 - Poor semi-improved grassland
- C1.1 - Bracken - continuous
- C3.1 - Other tall herb and fern - ruderal
- F1 - Swamp
- F2.1 - Marginal and inundation - marginal vegetation
- F2.2 - Marginal and inundation - inundation vegetation
- G1 - Standing water
- G1.1 - Standing water - eutrophic
- G1.2 - Standing water - mesotrophic
- G1.6 - Standing water - brackish
- G2 - Running water
- G2.6 - Running water - brackish
- H1.1 - Intertidal - mud/sand
- H2.3 - Saltmarsh/dune interface
- H2.6 - Saltmarsh - dense/continuous
- H6.5 - Dune grassland
- H8.4 - Coastal grassland
- I2.1 - Quarry
- I2.2 - Spoil
- J1.1 - Cultivated/disturbed land - arable
- J1.2 - Cultivated/disturbed land - amenity grassland
- J1.3 - Cultivated/disturbed land - ephemeral/short perennial
- J1.4 - Introduced shrub
- J2.1.1 - Intact hedge - native species-rich
- J2.1.2 - Intact hedge - species-poor
- J2.2.1 - Defunct hedge - native species-rich
- J2.2.2 - Defunct hedge - species-poor
- J2.3.1 - Hedge with trees - native species-rich
- J2.4 - Fence
- J2.6 - Dry ditch
- J3.5 - Artificial sea wall
- J3.6 - Buildings
- J4 - Bare ground
- Hardstanding

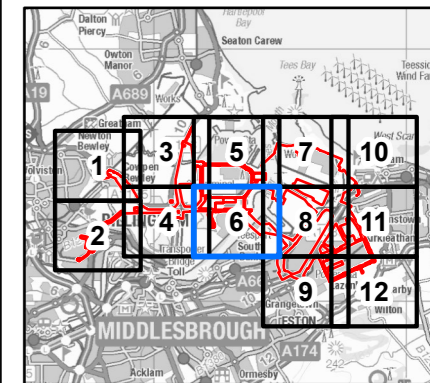

**NOTES**  
1: Contains Ordnance Survey Data © Crown Copyright and database right 2023.

**ISSUE PURPOSE**  
PEI Report

**PROJECT NUMBER**  
60689030

**FIGURE TITLE**  
Phase 1 Habitat Map (Draft)

**FIGURE NUMBER**  
Figure 12-4 (Sheet 6 of 12)

This drawing has been prepared for the use of AECOM's client. It may not be used, modified, reproduced or relied upon by third parties, except as agreed by AECOM or as required by law. AECOM accepts no responsibility, and denies any liability whatsoever, to any party that uses or relies on this drawing without AECOM's express written consent. All measurements must be obtained from the stated dimensions.

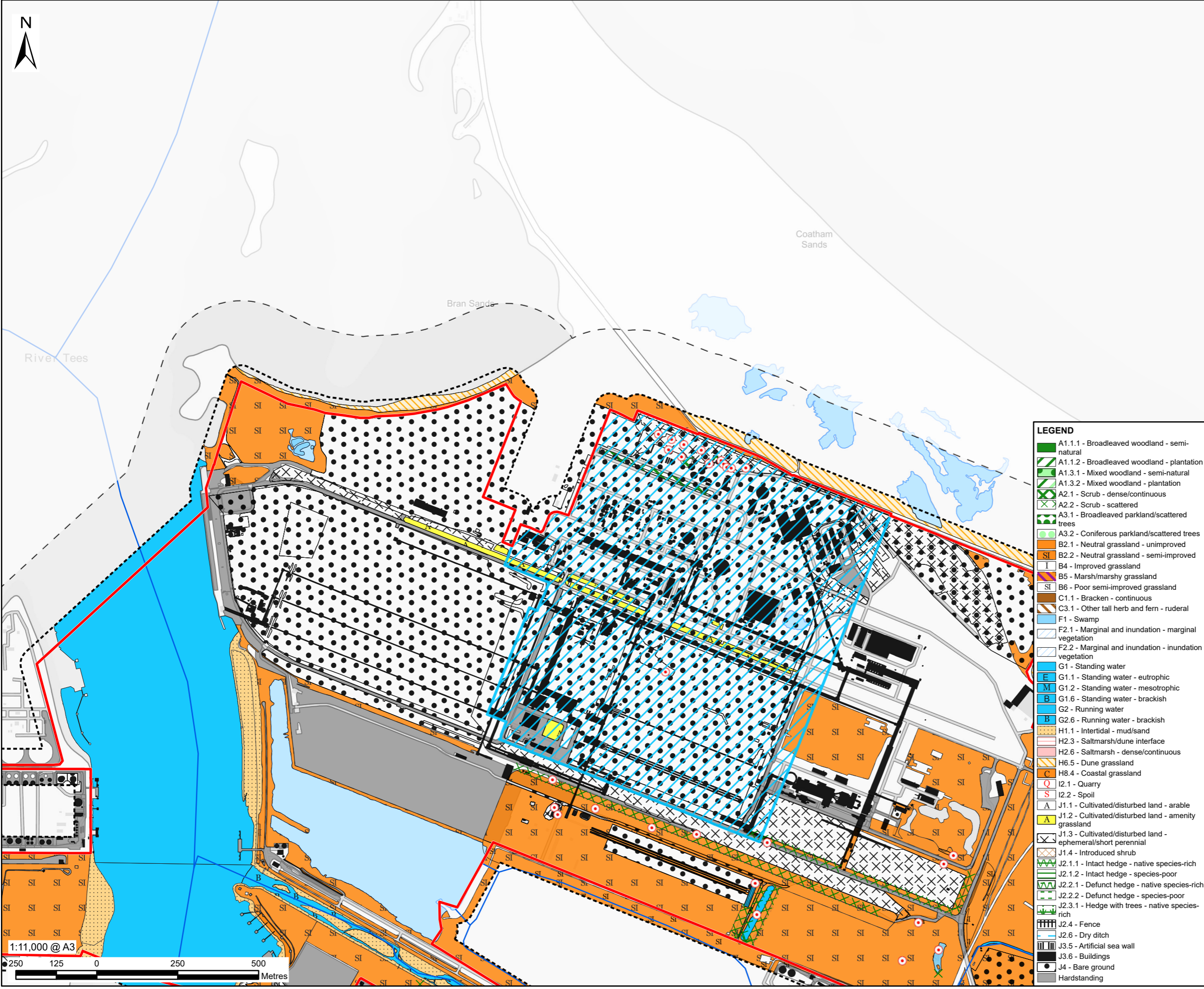

**LEGEND**

- Proposed Development Site Boundary
- Proposed Development Site Boundary - 50 m Buffer
- Proposed Development Site Boundary - 250 m Buffer
- Main Site
- Target Note
- × A2.2 - Scrub - scattered
- A3.1 - Broadleaved parkland/scattered trees
- J5 - Other habitat
- × A2.2 - Scrub - scattered
- J2.6 - Dry ditch
- J2.2.2 - Defunct hedge - species-poor
- J2.1.2 - Intact hedge - species-poor
- J2.3.2 - Hedge with trees - species-poor
- F2.1 - Marginal and inundation - marginal vegetation
- A3.1 - Broadleaved parkland/scattered trees
- G2 - Running water
- Watercourse
- Waterbody

**LEGEND**

- A1.1.1 - Broadleaved woodland - semi-natural
- A1.1.2 - Broadleaved woodland - plantation
- A1.3.1 - Mixed woodland - semi-natural
- A1.3.2 - Mixed woodland - plantation
- A2.1 - Scrub - dense/continuous
- A2.2 - Scrub - scattered
- A3.1 - Broadleaved parkland/scattered trees
- A3.2 - Coniferous parkland/scattered trees
- B2.1 - Neutral grassland - unimproved
- B2.2 - Neutral grassland - semi-improved
- B4 - Improved grassland
- B5 - Marsh/marshy grassland
- B6 - Poor semi-improved grassland
- C1.1 - Bracken - continuous
- C3.1 - Other tall herb and fern - ruderal
- F1 - Swamp
- F2.1 - Marginal and inundation - marginal vegetation
- F2.2 - Marginal and inundation - inundation vegetation
- G1 - Standing water
- G1.1 - Standing water - eutrophic
- G1.2 - Standing water - mesotrophic
- G1.6 - Standing water - brackish
- G2 - Running water
- G2.6 - Running water - brackish
- H1.1 - Intertidal - mud/sand
- H2.3 - Saltmarsh/dune interface
- H2.6 - Saltmarsh - dense/continuous
- H6.5 - Dune grassland
- H8.4 - Coastal grassland
- I2.1 - Quarry
- I2.2 - Spoil
- J1.1 - Cultivated/disturbed land - arable
- J1.2 - Cultivated/disturbed land - amenity grassland
- J1.3 - Cultivated/disturbed land - ephemeral/short perennial
- J1.4 - Introduced shrub
- J2.1.1 - Intact hedge - native species-rich
- J2.1.2 - Intact hedge - species-poor
- J2.2.1 - Defunct hedge - native species-rich
- J2.2.2 - Defunct hedge - species-poor
- J2.3.1 - Hedge with trees - native species-rich
- J2.4 - Fence
- J2.6 - Dry ditch
- J3.5 - Artificial sea wall
- J3.6 - Buildings
- J4 - Bare ground
- Hardstanding

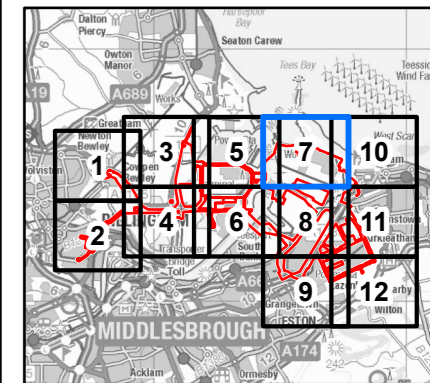

**NOTES**  
1: Contains Ordnance Survey Data © Crown Copyright and database right 2023.

**ISSUE PURPOSE**  
PEI Report

**PROJECT NUMBER**  
60689030

**FIGURE TITLE**  
Phase 1 Habitat Map (Draft)

**FIGURE NUMBER**  
Figure 12-4 (Sheet 7 of 12)

This drawing has been prepared for the use of AECOM's client. It may not be used, modified, reproduced or relied upon by third parties, except as agreed by AECOM, or as required by law. AECOM accepts no responsibility, and denies any liability whatsoever, to any party that uses or relies on this drawing without AECOM's express written consent. Do not scale this document. All measurements must be obtained from the stated dimensions.

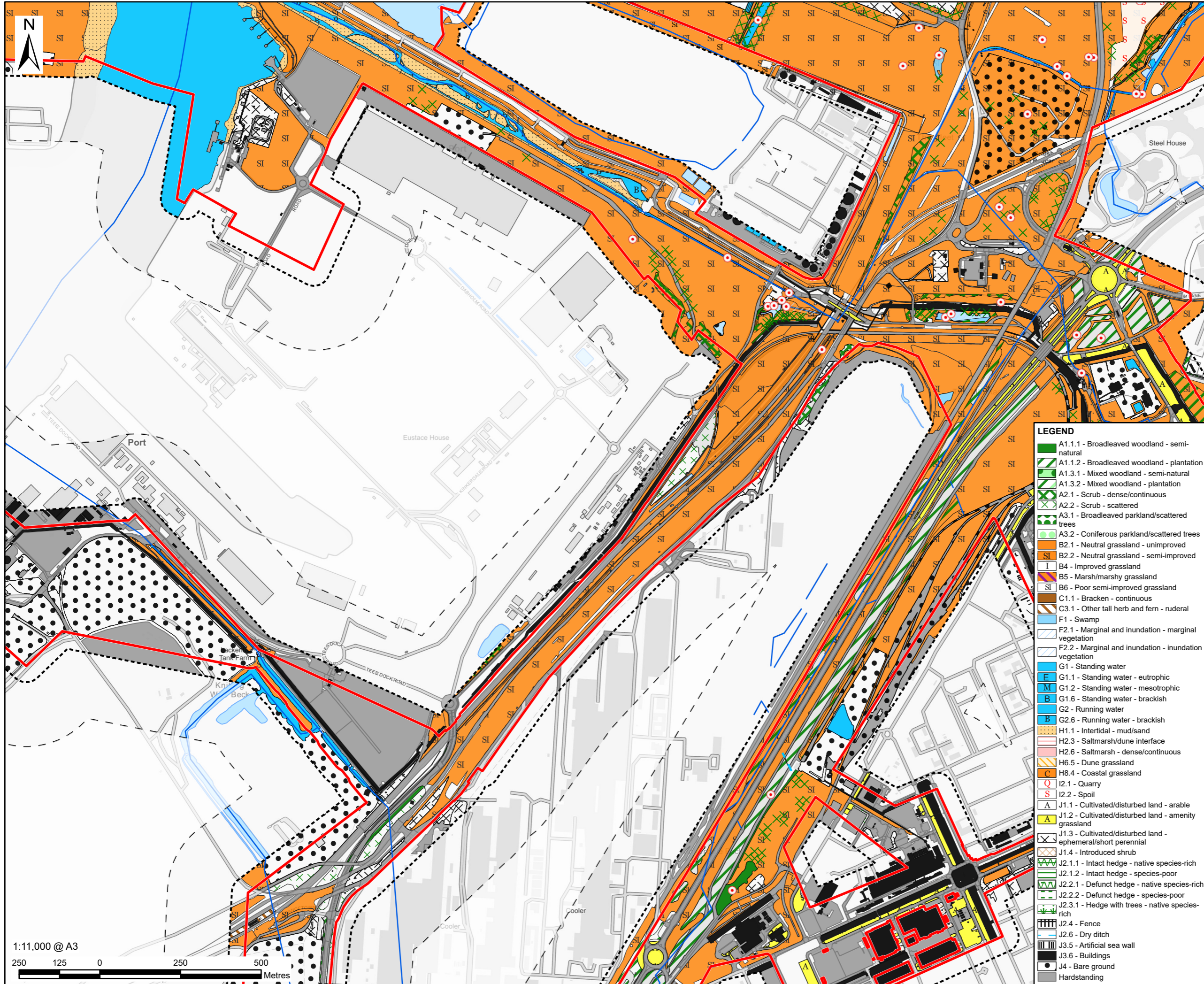

1:11,000 @ A3  
 250 125 0 250 500 Metres

LEGEND	
[Red outline]	Proposed Development Site Boundary
[Dashed red outline]	Proposed Development Site Boundary - 50 m Buffer
[Dotted red outline]	Proposed Development Site Boundary - 250 m Buffer
[Red circle]	Target Note
[Green X]	A2.2 - Scrub - scattered
[Green circle]	A3.1 - Broadleaved parkland/scattered trees
[Grey circle]	J5 - Other habitat
[Green X]	A2.2 - Scrub - scattered
[Blue line]	J2.6 - Dry ditch
[Green dashed line]	J2.2.2 - Defunct hedge - species-poor
[Green solid line]	J2.1.2 - Intact hedge - species-poor
[Green dashed line with trees]	J2.3.2 - Hedge with trees - species-poor
[Green dashed line]	F2.1 - Marginal and inundation - marginal vegetation
[Green circle]	A3.1 - Broadleaved parkland/scattered trees
[Blue line]	G2 - Running water
[Blue area]	Watercourse
[Blue area]	Waterbody
[Green area]	A1.1.1 - Broadleaved woodland - semi-natural
[Green area]	A1.1.2 - Broadleaved woodland - plantation
[Green area]	A1.3.1 - Mixed woodland - semi-natural
[Green area]	A1.3.2 - Mixed woodland - plantation
[Green area]	A2.1 - Scrub - dense/continuous
[Green area]	A2.2 - Scrub - scattered
[Green area]	A3.1 - Broadleaved parkland/scattered trees
[Green area]	A3.2 - Coniferous parkland/scattered trees
[Orange area]	B2.1 - Neutral grassland - unimproved
[Orange area]	B2.2 - Neutral grassland - semi-improved
[Orange area]	B4 - Improved grassland
[Orange area]	B5 - Marsh/marshy grassland
[Orange area]	B6 - Poor semi-improved grassland
[Orange area]	C1.1 - Bracken - continuous
[Orange area]	C3.1 - Other tall herb and fern - ruderal
[Blue area]	F1 - Swamp
[Blue area]	F2.1 - Marginal and inundation - marginal vegetation
[Blue area]	F2.2 - Marginal and inundation - inundation vegetation
[Blue area]	G1 - Standing water
[Blue area]	G1.1 - Standing water - eutrophic
[Blue area]	G1.2 - Standing water - mesotrophic
[Blue area]	G1.6 - Standing water - brackish
[Blue area]	G2 - Running water
[Blue area]	G2.6 - Running water - brackish
[Orange area]	H1.1 - Intertidal - mud/sand
[Orange area]	H2.3 - Saltmarsh/dune interface
[Orange area]	H2.6 - Saltmarsh - dense/continuous
[Orange area]	H6.5 - Dune grassland
[Orange area]	H8.4 - Coastal grassland
[Orange area]	I2.1 - Quarry
[Orange area]	I2.2 - Spoil
[Orange area]	J1.1 - Cultivated/disturbed land - arable
[Orange area]	J1.2 - Cultivated/disturbed land - amenity grassland
[Orange area]	J1.3 - Cultivated/disturbed land - ephemeral/short perennial
[Orange area]	J1.4 - Introduced shrub
[Green area]	J2.1.1 - Intact hedge - native species-rich
[Green area]	J2.1.2 - Intact hedge - species-poor
[Green area]	J2.2.1 - Defunct hedge - native species-rich
[Green area]	J2.2.2 - Defunct hedge - species-poor
[Green area]	J2.3.1 - Hedge with trees - native species-rich
[Green area]	J2.4 - Fence
[Blue area]	J2.6 - Dry ditch
[Blue area]	J3.5 - Artificial sea wall
[Grey area]	J3.6 - Buildings
[Grey area]	J4 - Bare ground
[Grey area]	Hardstanding

LEGEND

- [Red outline] Proposed Development Site Boundary
- [Dashed red outline] Proposed Development Site Boundary - 50 m Buffer
- [Dotted red outline] Proposed Development Site Boundary - 250 m Buffer
- [Red circle] Target Note
- [Green X] A2.2 - Scrub - scattered
- [Green circle] A3.1 - Broadleaved parkland/scattered trees
- [Grey circle] J5 - Other habitat
- [Green X] A2.2 - Scrub - scattered
- [Blue line] J2.6 - Dry ditch
- [Green dashed line] J2.2.2 - Defunct hedge - species-poor
- [Green solid line] J2.1.2 - Intact hedge - species-poor
- [Green dashed line with trees] J2.3.2 - Hedge with trees - species-poor
- [Green dashed line] F2.1 - Marginal and inundation - marginal vegetation
- [Green circle] A3.1 - Broadleaved parkland/scattered trees
- [Blue line] G2 - Running water
- [Blue area] Watercourse
- [Blue area] Waterbody

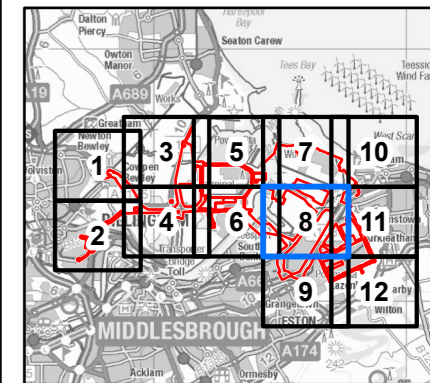

NOTES  
 1: Contains Ordnance Survey Data © Crown Copyright and database right 2023.

ISSUE PURPOSE  
 PEI Report

PROJECT NUMBER  
 60689030

FIGURE TITLE  
 Phase 1 Habitat Map (Draft)

FIGURE NUMBER  
 Figure 12-4 (Sheet 8 of 12)

This drawing has been prepared for the use of AECOM's client. It may not be used, modified, reproduced or relied upon by third parties, except as agreed by AECOM or as required by law. AECOM accepts no responsibility, and denies any liability whatsoever, to any party that uses or relies on this drawing without AECOM's express written consent. Do not scale this document. All measurements must be obtained from the stated dimensions.

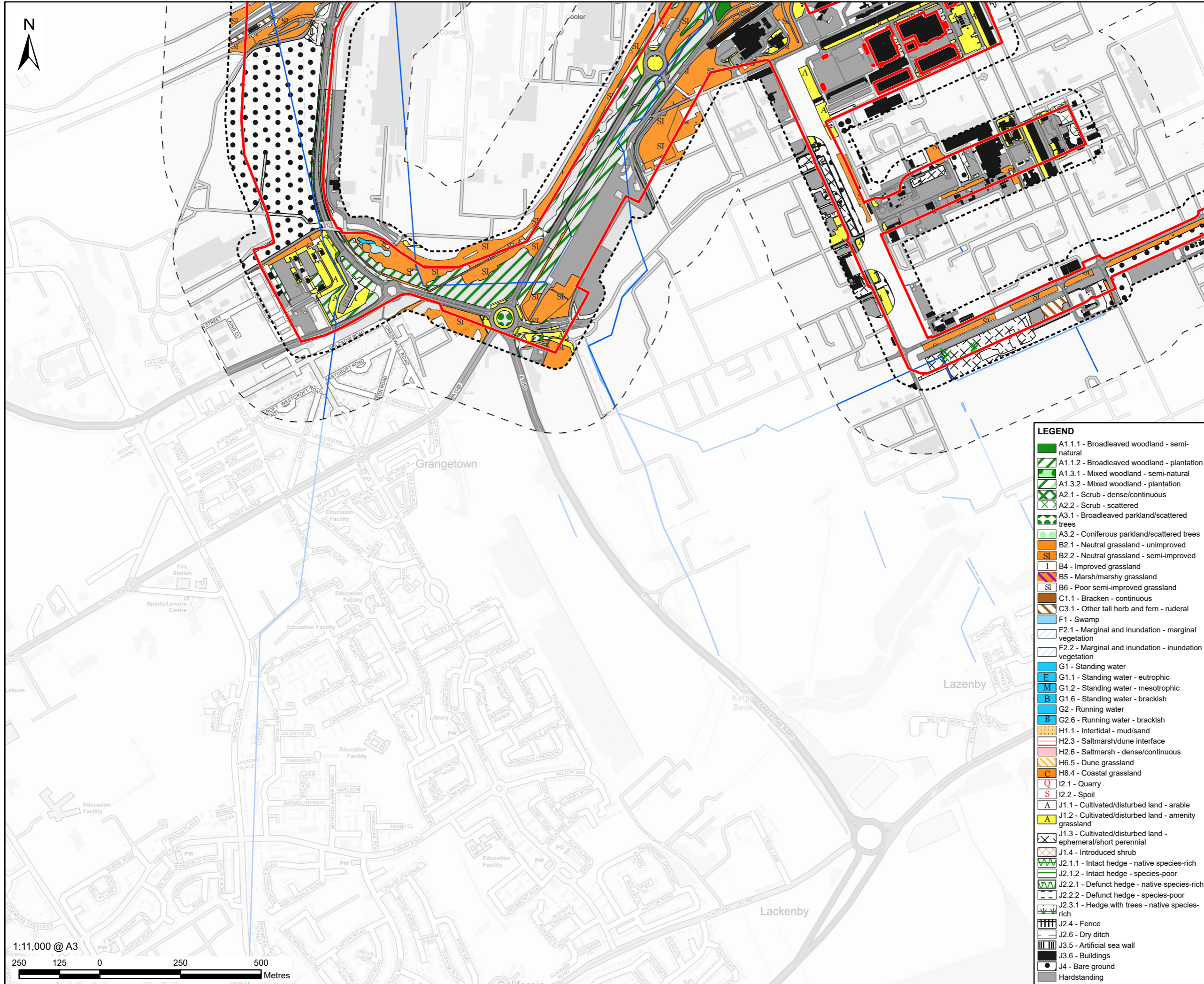

**LEGEND**

- Proposed Development Site Boundary
- Proposed Development Site Boundary - 50 m Buffer
- Proposed Development Site Boundary - 250 m Buffer
- Target Note
- A2.2 - Scrub - scattered
- A3.1 - Broadleaved parkland/scattered trees
- J5 - Other habitat
- X A2.2 - Scrub - scattered
- J2.6 - Dry ditch
- J2.2.2 - Defunct hedge - species-poor
- J2.1.2 - Intact hedge - species-poor
- J2.3.2 - Hedge with trees - species-poor
- F2.1 - Marginal and inundation - marginal vegetation
- A3.1 - Broadleaved parkland/scattered trees
- G2 - Running water
- Watercourse
- Waterbody

**LEGEND**

- A1.1.1 - Broadleaved woodland - semi-natural
- A1.1.2 - Broadleaved woodland - plantation
- A1.3.1 - Mixed woodland - semi-natural
- A1.3.2 - Mixed woodland - plantation
- A2.1 - Scrub - dense/continuous
- A2.2 - Scrub - scattered
- A3.1 - Broadleaved parkland/scattered trees
- A3.2 - Coniferous parkland/scattered trees
- B2.1 - Neutral grassland - unimproved
- B2.2 - Neutral grassland - semi-improved
- B4 - Improved grassland
- B5 - Marsh/marshy grassland
- B6 - Poor semi-improved grassland
- C1.1 - Bracken - continuous
- C3.1 - Other tall herb and fern - ruderal
- F1 - Swamp
- F2.1 - Marginal and inundation - marginal vegetation
- F2.2 - Marginal and inundation - inundation vegetation
- G1 - Standing water
- G1.1 - Standing water - eutrophic
- G1.2 - Standing water - mesotrophic
- G1.6 - Standing water - brackish
- G2 - Running water
- G2.6 - Running water - brackish
- H1.1 - Intertidal - mud/sand
- H2.3 - Saltmarsh/dune interface
- H2.6 - Saltmarsh - dense/continuous
- H6.5 - Dune grassland
- H8.4 - Coastal grassland
- I2.1 - Quarry
- I2.2 - Spoil
- J1.1 - Cultivated/disturbed land - arable
- J1.2 - Cultivated/disturbed land - amenity grassland
- J1.3 - Cultivated/disturbed land - ephemeral/short perennial
- J1.4 - Introduced shrub
- J2.1.1 - Intact hedge - native species-rich
- J2.1.2 - Intact hedge - species-poor
- J2.2.1 - Defunct hedge - native species-rich
- J2.2.2 - Defunct hedge - species-poor
- J2.3.1 - Hedge with trees - native species-rich
- J2.4 - Fence
- J2.6 - Dry ditch
- J3.5 - Artificial sea wall
- J3.6 - Buildings
- J4 - Bare ground
- Hardstanding

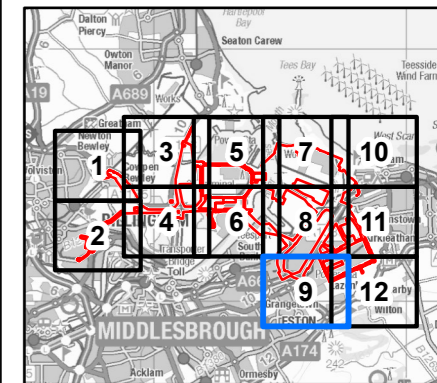

**NOTES**

1: Contains Ordnance Survey Data © Crown Copyright and database right 2023.

**ISSUE PURPOSE**  
PEI Report

**PROJECT NUMBER**  
60689030

**FIGURE TITLE**  
Phase 1 Habitat Map (Draft)

**FIGURE NUMBER**  
Figure 12-4 (Sheet 9 of 12)

This drawing has been prepared for the use of AECOM's client. It may not be used, modified, reproduced or relied upon by third parties, except as agreed by AECOM or as required by law. AECOM accepts no responsibility, and denies any liability whatsoever, to any party that uses or relies on this drawing without AECOM's express written consent. Do not scale this document. All measurements must be obtained from the stated dimensions.

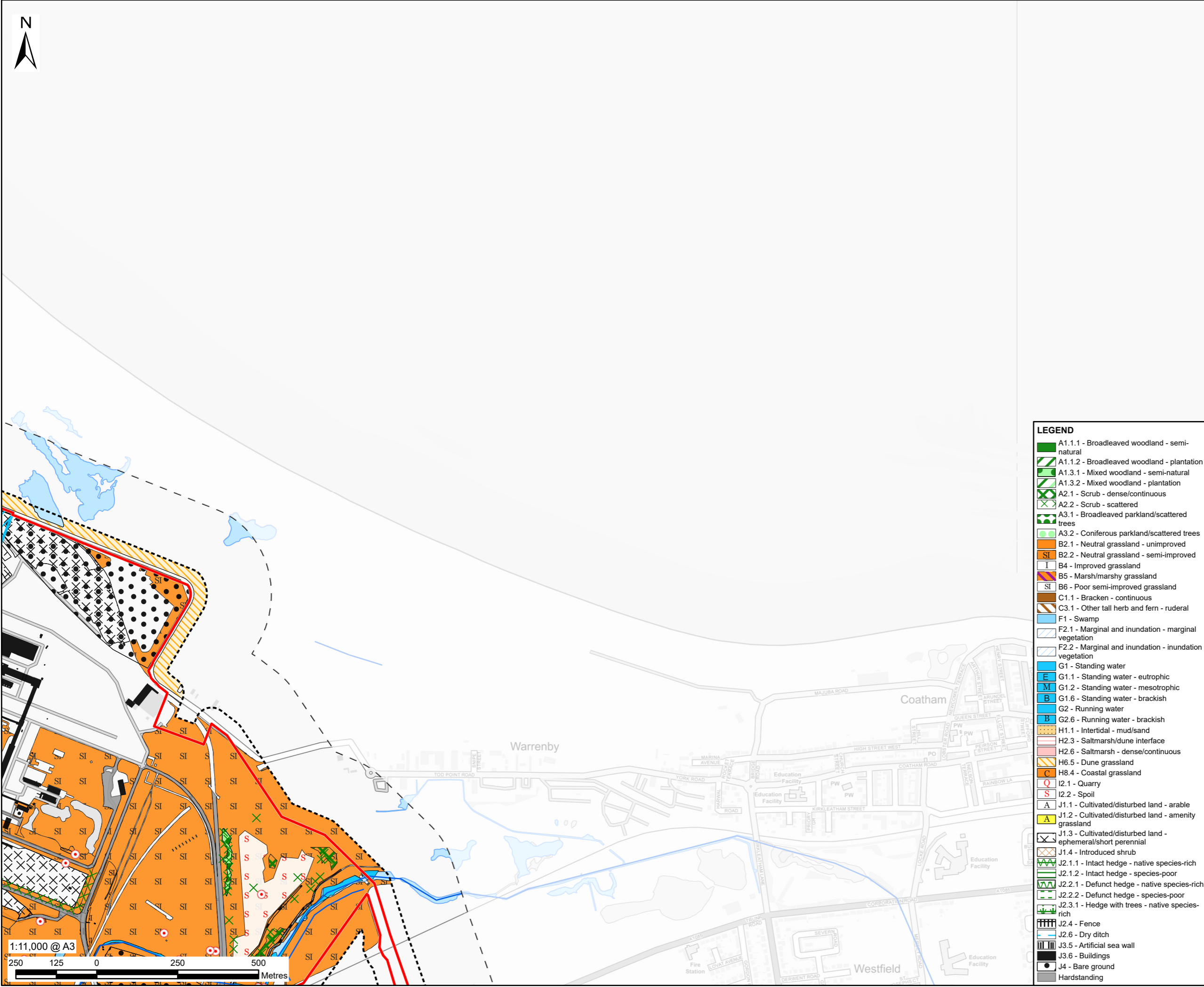

**LEGEND**

- A1.1.1 - Broadleaved woodland - semi-natural
- A1.1.2 - Broadleaved woodland - plantation
- A1.3.1 - Mixed woodland - semi-natural
- A1.3.2 - Mixed woodland - plantation
- A2.1 - Scrub - dense/continuous
- A2.2 - Scrub - scattered
- A3.1 - Broadleaved parkland/scattered trees
- A3.2 - Coniferous parkland/scattered trees
- B2.1 - Neutral grassland - unimproved
- B2.2 - Neutral grassland - semi-improved
- B4 - Improved grassland
- B5 - Marsh/marshy grassland
- B6 - Poor semi-improved grassland
- C1.1 - Bracken - continuous
- C3.1 - Other tall herb and fern - ruderal
- F1 - Swamp
- F2.1 - Marginal and inundation - marginal vegetation
- F2.2 - Marginal and inundation - inundation vegetation
- G1 - Standing water
- G1.1 - Standing water - eutrophic
- G1.2 - Standing water - mesotrophic
- G1.6 - Standing water - brackish
- G2 - Running water
- G2.6 - Running water - brackish
- H1.1 - Intertidal - mud/sand
- H2.3 - Saltmarsh/dune interface
- H2.6 - Saltmarsh - dense/continuous
- H6.5 - Dune grassland
- H8.4 - Coastal grassland
- I2.1 - Quarry
- I2.2 - Spoil
- J1.1 - Cultivated/disturbed land - arable
- J1.2 - Cultivated/disturbed land - amenity grassland
- J1.3 - Cultivated/disturbed land - ephemeral/short perennial
- J1.4 - Introduced shrub
- J2.1.1 - Intact hedge - native species-rich
- J2.1.2 - Intact hedge - species-poor
- J2.2.1 - Defunct hedge - native species-rich
- J2.2.2 - Defunct hedge - species-poor
- J2.3.1 - Hedge with trees - native species-rich
- J2.4 - Fence
- J3.5 - Artificial sea wall
- J3.6 - Buildings
- J4 - Bare ground
- Hardstanding

**LEGEND**

- Proposed Development Site Boundary
- Proposed Development Site Boundary - 50 m Buffer
- Proposed Development Site Boundary - 250 m Buffer
- Target Note
- A2.2 - Scrub - scattered
- A3.1 - Broadleaved parkland/scattered trees
- J5 - Other habitat
- A2.2 - Scrub - scattered
- J2.6 - Dry ditch
- J2.2.2 - Defunct hedge - species-poor
- J2.1.2 - Intact hedge - species-poor
- J2.3.2 - Hedge with trees - species-poor
- F2.1 - Marginal and inundation - marginal vegetation
- A3.1 - Broadleaved parkland/scattered trees
- G2 - Running water
- Watercourse
- Waterbody

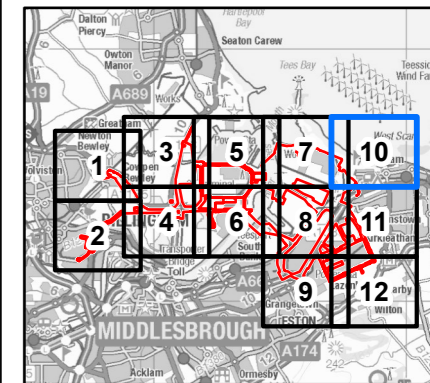

**NOTES**

1: Contains Ordnance Survey Data © Crown Copyright and database right 2023.

**ISSUE PURPOSE**  
PEI Report

**PROJECT NUMBER**  
60689030

**FIGURE TITLE**  
Phase 1 Habitat Map (Draft)

**FIGURE NUMBER**  
Figure 12-4 (Sheet 10 of 12)

This drawing has been prepared for the use of AECOM's client. It may not be used, modified, reproduced or relied upon by third parties, except as agreed by AECOM or as required by law. AECOM accepts no responsibility, and denies any liability whatsoever, to any party that uses or relies on this drawing without AECOM's express written consent. Do not scale this document. All measurements must be obtained from the stated dimensions.

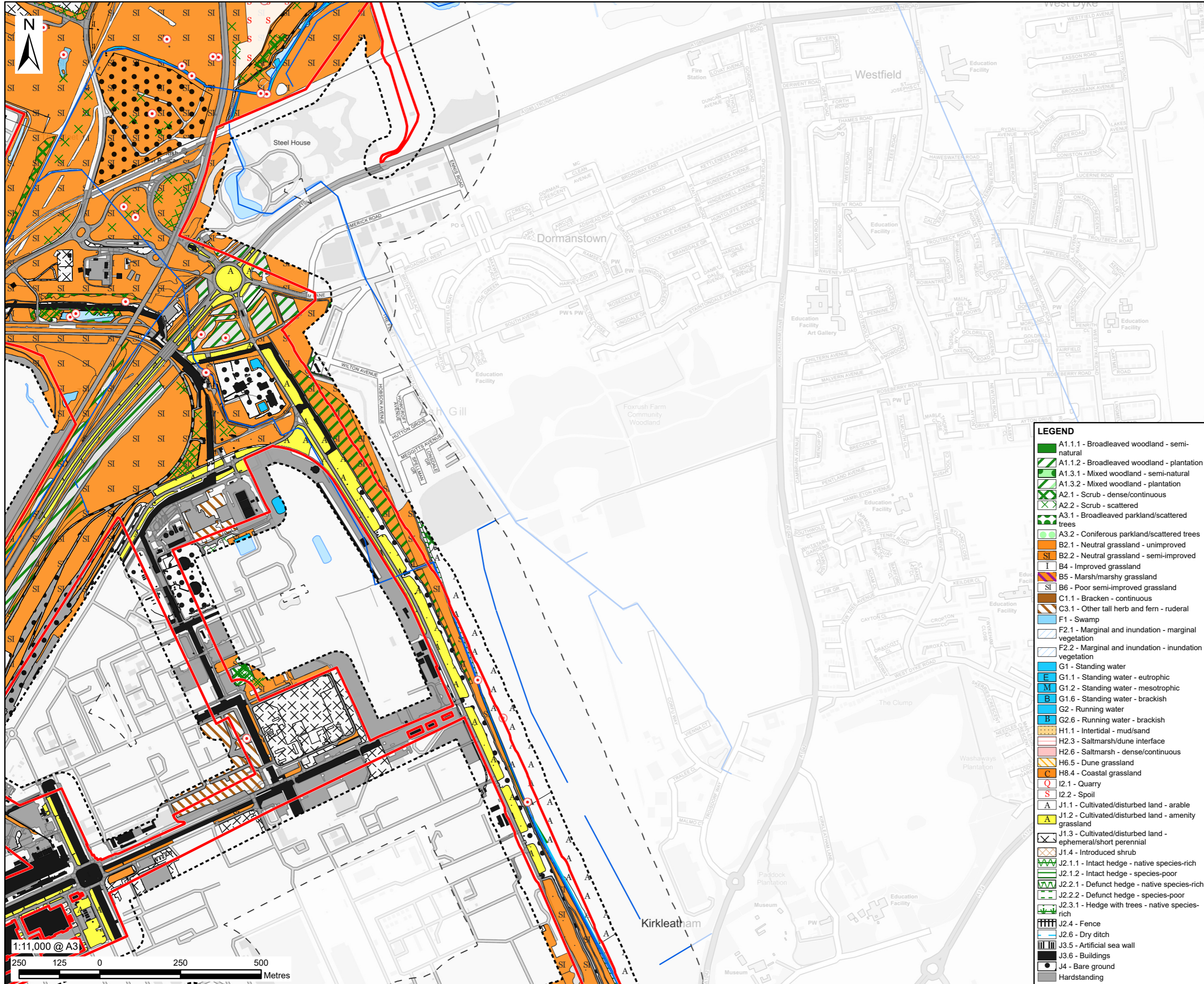

**LEGEND**

- Proposed Development Site Boundary
- Proposed Development Site Boundary - 50 m Buffer
- Proposed Development Site Boundary - 250 m Buffer
- Target Note
- X A2.2 - Scrub - scattered
- X A3.1 - Broadleaved parkland/scattered trees
- J5 - Other habitat
- X A2.2 - Scrub - scattered
- X J2.6 - Dry ditch
- X J2.2.2 - Defunct hedge - species-poor
- X J2.1.2 - Intact hedge - species-poor
- X J2.3.2 - Hedge with trees - species-poor
- X F2.1 - Marginal and inundation - marginal vegetation
- X A3.1 - Broadleaved parkland/scattered trees
- X G2 - Running water
- X Watercourse
- X Waterbody

**LEGEND**

- A1.1.1 - Broadleaved woodland - semi-natural
- A1.1.2 - Broadleaved woodland - plantation
- A1.3.1 - Mixed woodland - semi-natural
- A1.3.2 - Mixed woodland - plantation
- A2.1 - Scrub - dense/continuous
- A2.2 - Scrub - scattered
- A3.1 - Broadleaved parkland/scattered trees
- A3.2 - Coniferous parkland/scattered trees
- B2.1 - Neutral grassland - unimproved
- B2.2 - Neutral grassland - semi-improved
- B4 - Improved grassland
- B5 - Marsh/marshy grassland
- B6 - Poor semi-improved grassland
- C1.1 - Bracken - continuous
- C3.1 - Other tall herb and fern - ruderal
- F1 - Swamp
- F2.1 - Marginal and inundation - marginal vegetation
- F2.2 - Marginal and inundation - inundation vegetation
- G1 - Standing water
- G1.1 - Standing water - eutrophic
- G1.2 - Standing water - mesotrophic
- G1.6 - Standing water - brackish
- G2 - Running water
- G2.6 - Running water - brackish
- H1.1 - Intertidal - mud/sand
- H2.3 - Saltmarsh/dune interface
- H2.6 - Saltmarsh - dense/continuous
- H6.5 - Dune grassland
- H8.4 - Coastal grassland
- I2.1 - Quarry
- I2.2 - Spoil
- J1.1 - Cultivated/disturbed land - arable
- J1.2 - Cultivated/disturbed land - amenity grassland
- J1.3 - Cultivated/disturbed land - ephemeral/short perennial
- J1.4 - Introduced shrub
- J2.1.1 - Intact hedge - native species-rich
- J2.1.2 - Intact hedge - species-poor
- J2.2.1 - Defunct hedge - native species-rich
- J2.2.2 - Defunct hedge - species-poor
- J2.3.1 - Hedge with trees - native species-rich
- J2.4 - Fence
- J2.6 - Dry ditch
- J3.5 - Artificial sea wall
- J3.6 - Buildings
- J4 - Bare ground
- Hardstanding

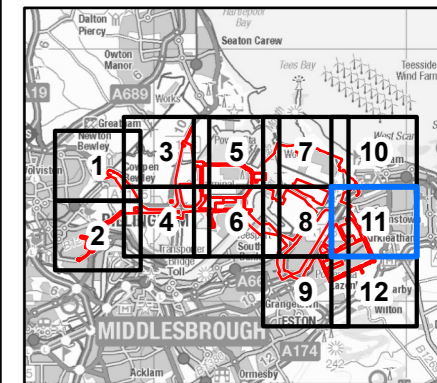

**NOTES**  
1: Contains Ordnance Survey Data © Crown Copyright and database right 2023.

**ISSUE PURPOSE**  
PEI Report

**PROJECT NUMBER**  
60689030

**FIGURE TITLE**  
Phase 1 Habitat Map (Draft)

**FIGURE NUMBER**  
Figure 12-4 (Sheet 11 of 12)

This drawing has been prepared for the use of AECOM's client. It may not be used, modified, reproduced or relied upon by third parties, except as agreed by AECOM or as required by law. AECOM accepts no responsibility, and denies any liability whatsoever, to any party that uses or relies on this drawing without AECOM's express written consent. Do not scale this document. All measurements must be obtained from the stated dimensions.

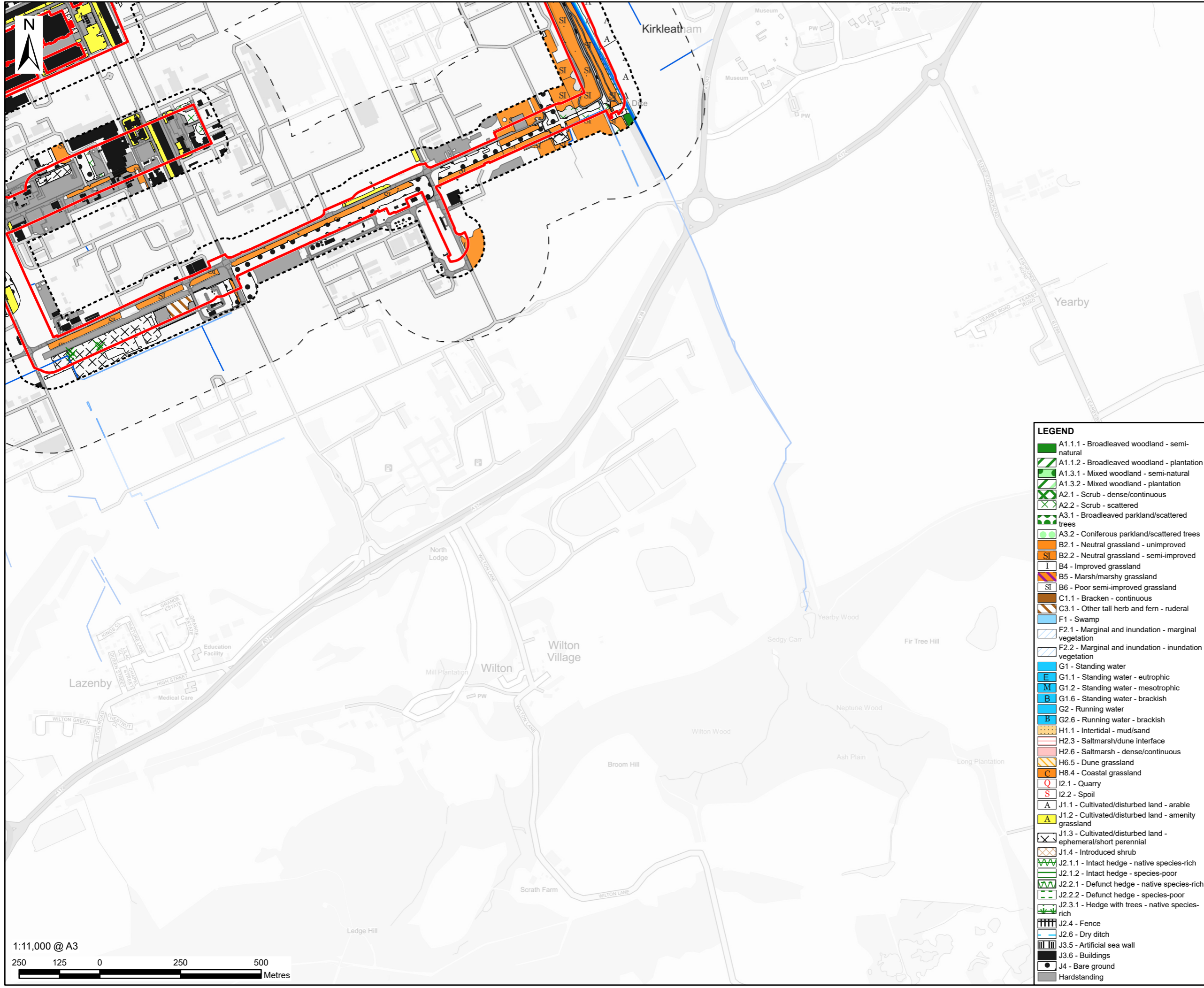

**LEGEND**

- Proposed Development Site Boundary
- Proposed Development Site Boundary - 50 m Buffer
- Proposed Development Site Boundary - 250 m Buffer
- Target Note
- X A2.2 - Scrub - scattered
- A3.1 - Broadleaved parkland/scattered trees
- J5 - Other habitat
- X A2.2 - Scrub - scattered
- J2.6 - Dry ditch
- J2.2.2 - Defunct hedge - species-poor
- J2.1.2 - Intact hedge - species-poor
- + J2.3.2 - Hedge with trees - species-poor
- F2.1 - Marginal and inundation - marginal vegetation
- A3.1 - Broadleaved parkland/scattered trees
- G2 - Running water
- Watercourse
- Waterbody

**LEGEND**

- A1.1.1 - Broadleaved woodland - semi-natural
- ▨ A1.1.2 - Broadleaved woodland - plantation
- ▨ A1.3.1 - Mixed woodland - semi-natural
- ▨ A1.3.2 - Mixed woodland - plantation
- ▨ A2.1 - Scrub - dense/continuous
- X A2.2 - Scrub - scattered
- A3.1 - Broadleaved parkland/scattered trees
- A3.2 - Coniferous parkland/scattered trees
- B2.1 - Neutral grassland - unimproved
- B2.2 - Neutral grassland - semi-improved
- B4 - Improved grassland
- B5 - Marsh/marshy grassland
- B6 - Poor semi-improved grassland
- C1.1 - Bracken - continuous
- C3.1 - Other tall herb and fern - ruderal
- F1 - Swamp
- F2.1 - Marginal and inundation - marginal vegetation
- F2.2 - Marginal and inundation - inundation vegetation
- G1 - Standing water
- E G1.1 - Standing water - eutrophic
- M G1.2 - Standing water - mesotrophic
- B G1.6 - Standing water - brackish
- G2 - Running water
- B G2.6 - Running water - brackish
- H1.1 - Intertidal - mud/sand
- H2.3 - Saltmarsh/dune interface
- H2.6 - Saltmarsh - dense/continuous
- H6.5 - Dune grassland
- H8.4 - Coastal grassland
- Q I2.1 - Quarry
- S I2.2 - Spoil
- A J1.1 - Cultivated/disturbed land - arable
- A J1.2 - Cultivated/disturbed land - amenity grassland
- X J1.3 - Cultivated/disturbed land - ephemeral/short perennial
- X J1.4 - Introduced shrub
- J2.1.1 - Intact hedge - native species-rich
- J2.1.2 - Intact hedge - species-poor
- J2.2.1 - Defunct hedge - native species-rich
- J2.2.2 - Defunct hedge - species-poor
- J2.3.1 - Hedge with trees - native species-rich
- J2.4 - Fence
- J2.6 - Dry ditch
- J3.5 - Artificial sea wall
- J3.6 - Buildings
- J4 - Bare ground
- Hardstanding

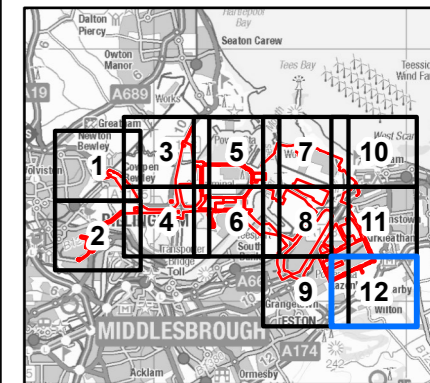

**NOTES**  
1: Contains Ordnance Survey Data © Crown Copyright and database right 2023.

**ISSUE PURPOSE**  
PEI Report

**PROJECT NUMBER**  
60689030

**FIGURE TITLE**  
Phase 1 Habitat Map (Draft)

**FIGURE NUMBER**  
Figure 12-4 (Sheet 12 of 12)



This drawing has been prepared for the use of AECOM's client. It may not be used, modified, reproduced or relied upon by third parties, except as agreed by AECOM or as required by law. AECOM accepts no responsibility, and denies any liability whatsoever, to any party that uses or relies on this drawing without AECOM's express written consent. Do not scale this document. All measurements must be obtained from the stated dimensions.